

SECTION A-A

NOTE : SIZE OF FOUNDATIONS TO BE DESIGNED BY CIVIL ENGINEER FOR LOCAL SITE CONDITIONS

ROOF
 INTERLOCKING CONCRETE TILES ON 38 x 38mm BATTENS ON PREFABRICATED NAILPLATED ROOF TRUSSES TO ENGINEER'S DESIGN. TRUSSES SPACED AT MAX 750mm CENTRES ON 75 x 38mm WALLPLATES AND TIED DOWN FOUR COURSES INTO BLOCKWORK.

CEILINGS : 6mm PLASTERBOARD ON 38 x 38mm BRANDING SPACED AT 400mm CENTRES. 75mm COVED CORNICES AT PERIMETERS.

WALLS
 EXTERNAL WALLS : 220mm HYDRAFORM BLOCKS, PLASTERED AROUND WINDOWS AND DOORS, AND AT EXTERNAL CORNERS TO CONCEAL BLOCK ENDS.
 INTERNAL WALLS : 140mm HYDRAFORM BLOCKS, TIED INTO EXTERNAL BLOCKWORK WITH GALVANISED HOOP IRON.
 PRECAST CONCRETE LINTELS BUILT INTO WALLS OVER DOORS AND WINDOWS.
 INTERNAL WALLS TO BE PLASTERED.

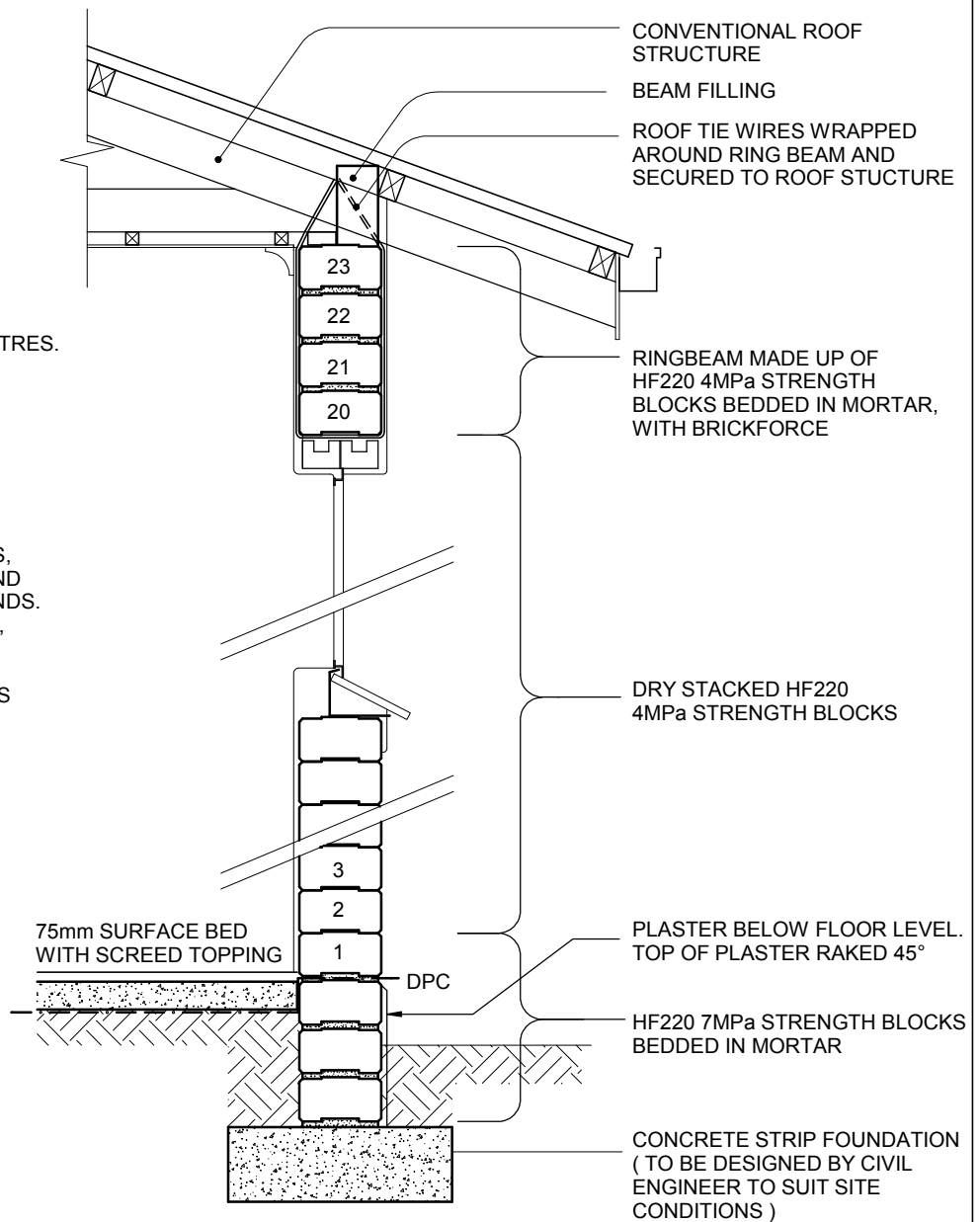

DETAIL A

SEE ALSO :
 RD96-06 & -07



www.hydraform.co.za

©HYDRAFORM 2008

HOUSE TYPE 1 (f) - LUXURY - SINGLE STOREY
 SECTION A-A AND DETAILS

DRAWING No
 RD96-08

REVISION -